

**Drain:** HUNTERS CREEK SOUTH DRAIN      **Drain #:** 188  
**Improvement/Arm:** HUNTERS CREEK SOUTH-SECTION A  
**Operator:** JOH      **Date:** 12-24-03  
**Drain Classification:** Urban/Rural      **Year Installed:** 1985

### GIS Drain Input Checklist

- Pull Source Documents for Scanning JA 12-24
- Digitize & Attribute Tile Drains JA 12-29
- Digitize & Attribute Storm Drains JA 12-29
- Digitize & Attribute SSD JA
- Digitize & Attribute Open Ditch N/A
- Stamp Plans JA 12-29
- Sum drain lengths & Validate JA 12-29
- Enter Improvements into Posse JA 12-29
- Enter Drain Age into Posse \_\_\_\_\_
- Sum drain length for Watershed in Posse \_\_\_\_\_
- Check Database entries for errors JA 12-29

**Gasb 34 Footages for Historical Cost**  
**Drain Length Log**

Drain-Improvement: HUNTER'S CREEK SOUTH DRAIN - HUNTER'S CREEK SOUTH - SECTION 4

Drain Type:	Size:	Length (AS BUILTS)	Length (DB Query)	Length Reconcile	If Applicable	
					Price:	Cost:
SSO	6"	1,257'	1,257'	Ø		
RCP	12"	1,492'	1,492'	Ø		
	15"	431'	396'	-35'		
	18"	305'	305'	Ø		
	24"	134'	134'	Ø		
	27"	451'	451'	Ø		
	36"	30'	30'	Ø		
	42"	40'	40'	Ø		
TILE	10"	500'	500'	Ø		
SWALE		470'	470'	Ø		

Sum: 5,110'      5,075'      -35'

Final Report: \_\_\_\_\_

Comments:

15" PIPE UNDER ROLLER RD. BETWEEN STR 130 + 131 NOT IN LENGTHS FOR THIS ARM. THIS PIPE  
IS IN THE LENGTHS FOR ANTIMONIES.

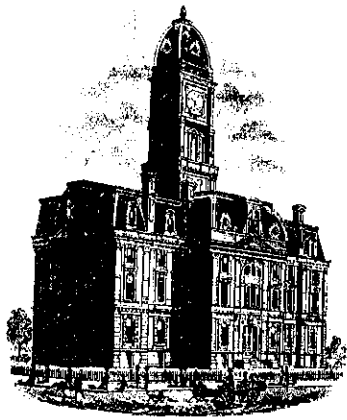

SURVEYOR'S OFFICE  
**Hamilton County**

Kenton C. Ward, Surveyor

776-9626

Noblesville, Ind. 46060 May 11, 1984

TO: Hamilton County Drainage Board

RE: Hunters Creek South, Section I Drain

Attached are plans, profiles, petition, engineers estimate, calculations and assessment roll for Hunters Creek South, Section I Drain.

I have reviewed the petition and found it to be in proper form. I have also reviewed the material pertaining to the drain along with personally inspecting the site and upon doing so I believe that the proposed drain is practicable, will improve the public health, benefit a public highway, be of public utility and that the cost, damages and expenses of the proposed drain will probably be less than the bebenefits accuring to the owners of land likely to be benefited.

The drain will consist of those items listed in the engineers estimate. Not listed in the estimate is 470 feet of open swale and approximately 500 feet of existing 10 inch clay tile. The total lenght for the drain will be 5116 feet.

Sheet D-1 of 1 shows the offsite drain improvements. The offsite drainage affects three (3) existing swales. The swale furthest South, not shown, and the center swale across the Marlowe property will not become part of the regulated drain. The North swale will be part of the regulated drain. This will involve the portion between the railroad and Rohrer Road, consisting of 500feet of an existing ten (10) inch tile and 470 feet of new swale.

The development will consist of 42 Lots and 11.65 acres of road right of way. Assessed at \$25.00/ lot and \$3.00/acre the total yearly

assessment will be \$1084.96. The surrounding properties such as Sheet 1 Noblesville, In 46060

Oil Company and Calvin and Mary Lassiter and others in the drainage  
shed have not been assessed.

I believe a hearing should be set for June 11, 1984 at 9:30am.

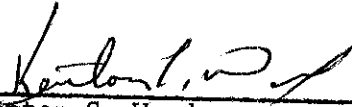
  
\_\_\_\_\_  
Kenton C. Ward  
Hamilton County Surveyor

KCW/no

STATE OF INDIANA }  
COUNTY OF HAMILTON } SS:

**FILED**

To: Hamilton County Drainage Board, Noblesville, Indiana  
c/o County Surveyor, Courthouse, Noblesville, Indiana

FEB 7 1984  
HAMILTON COUNTY DRAINAGE BOARD

SECRETARY

In the matter of Hunter's Creek South Subdivision, Sections  
one Drain Petition.

Petitioner is the owner of all lots in the land affected by the proposed new legal drain. The drainage will affect various lots in Hunter's Creek South Section I a subdivision in Hamilton County, Indiana. The general route of such drainage shall be in existing easements and along public roads as shown in the plans on file in the Surveyor's Office.

Petitioner believes that the cost, damages and expenses of the proposed improvement will be less than the benefits which will result to the owners of the land likely to be benefited thereby. Petitioner believes the proposed improvement will:

- (a) improve public health
- (b) benefit a public street
- (c) be of public utility

Petitioner agrees to pay the cost of construction of the storm sewers and requests periodic maintenance assessments by the Board thereafter. The Petitioner also agrees to the following:

1. To provide the Drainage Board a performance bond for the portion of the storm sewer system which will be made a legal drain. The bond will be in the amount of 100% of the Engineers estimate. Bond will be in effect until construction of 100% of the system is completed and so certified by the Engineer.
2. The Developer shall retain the Engineer throughout the construction phase. At completion of the project the Developers Engineer shall certify that the storm sewer system which is to be maintained as a legal drain has been constructed as per construction plans.
3. Any changes made in the field shall be documented and given to the Surveyor to be placed the the Drain file.
4. The developer shall instruct his Engineer to provide a reproducible print on a 24" x 36" mylar of the final design of the Drainage System.

The Petitioner further requests that the Drain be classified as an Urban Drain.

  
Owner SCHUTZ & THOMPSON, INC.

PROJECT: HUNTERS CREEK SOUTH - SECTION I

277.01

DATE: 5-1-84

ITEM	DESCRIPTION	QUANTITY	UNIT	UNIT PRICE	TOTAL
1.	STORM SEWER :				
2.	12" RCP	1201	L.F.	\$ 11.50	\$ 13,811.50
3.	15" RCP	685	L.F.	12.50	8,562.50
4.	18" RCP.	305	L.F.	16.00	4,880.00
5.	24" RCP.	145	L.F.	23.00	3,335.00
6.	27" RCP	460	L.F.	26.00	11,960.00
7.	36" RCP	30	L.F.	32.50	975.00
8.	42" RCP	40	L.F.	38.00	1,520.00
9.	STRUCTURES :				
10.	STREET CURB INLETS	14	EA.	\$ 550.00	7,700.00
11.	BEE HIVES	5	EA.	550.00	2,750.00
12.	STANDARD MANHOLES	1	EA.	750.00	750.00
13.	SPECIAL CURB INLETS	2	EA.	750.00	1,500.00
14.	SPECIAL BEE HIVE.	2	EA.	750.00	1,500.00
15.	DRAINAGE TILE RISER	1	EA.	100.00	100.00
16.	END SECTIONS :				
17.	12"	1	EA.	\$ 125.00	125.00
18.	15"	3	EA.	150.00	450.00
19.	27"	1	EA.	200.00	200.00
20.	36"	1	EA.	250.00	250.00
21.	42"	1	EA.	300.00	300.00
22.	SUB SURFACE DRAIN				
23.	8" (lots)	<del>1280</del> 940	L.F.	6.50	<del>8320.00</del> 6110.00
24.	8" (retention/offsite)	340	L.F.	6.50	2210.00
25.					
26.	RIPRAP	48	S.Y.	10.00	480.00
27.	CONCRETE RET. WALL (10' x 5' x 6")	1	EA.	300.00	300.00
28.	RETENTION POND	4800	C.Y.	2.50	12,000.00
29.	OFFSITE DRAINAGE SWALES	780	C.Y.	2.50	1,950.00
30.					
31.	TOTAL			\$	83,719.00 <del>85,979.00</del>

# 1A  
9-3-85

# Fidelity and Deposit Company

HOME OFFICE OF MARYLAND BALTIMORE, MD. 21203

SUBDIVISION BOND  
#98 77 666

BOOK 8 PAGE 610

KNOW ALL MEN BY THESE PRESENTS, That we, Central Engineering & Construction Corp. as Principal, and Fidelity and Deposit Company of Maryland, of Baltimore, Maryland, as Surety, are held and firmly bound unto the Hamilton County Board of Commissioners in the sum of Eighty Two Thousand Five Hundred & no/100 (\$ 82,500.00) Dollars for the payment of which, well and truly to be made, we jointly and severally bind ourselves, our heirs, legatees, executors, administrators, personal representatives, successors and assigns firmly by these presents.

Sealed with our seals and dated this 5th day of August 19 85.

THE CONDITIONS OF THE ABOVE OBLIGATION ARE SUCH THAT:

Whereas, the Hamilton County Board of Commissioners has granted Central Engineering & Construction Corp. a permit to construct Storm Sewers, Hunters Creek South

Now, if said Central Engineering & Construction Corp. shall improve said Storm Sewers in accordance with specifications and regulations of the Hamilton County Board of Commissioners and comply with all of the provisions of said permit then this obligation to be void, otherwise to be and remain in full force and effect.

CENTRAL ENGINEERING & CONSTRUCTION CORP.

BY: Donald A. Hart

FIDELITY AND DEPOSIT COMPANY OF MARYLAND

BY: Jan L. Jacobs, Attorney-in-Fact

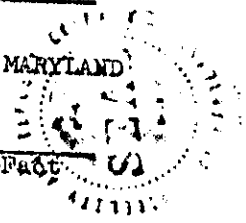

RECEIVED FOR RECORD  
Mar 11 9 44 AM '86  
MARY L. CLARK  
RECORDER HAMILTON CO. IN.

BOARD OF COMMISSIONERS OF THE COUNTY OF HAMILTON  
John Roach  
Philip Adams  
Philip Adams  
DATE Sept 3, 1985

This Instrument Recorded 3-11 1986  
Mary L. Clark, Recorder Hamilton County, Md.

ATTEST RELEASE OF MAINTENANCE/PERFORMANCE BOND  
HAMILTON COUNTY BOARD OF COMMISSIONERS

BY: \_\_\_\_\_

BY: \_\_\_\_\_

BY: \_\_\_\_\_

DATED: \_\_\_\_\_

ATTEST: \_\_\_\_\_  
HAMILTON COUNTY AUDITOR

01131-30M, 8-72 101114

RCNNR &

610



SURVEYOR'S OFFICE  
**Hamilton County**

Kenton C. Ward, Surveyor

Suite 146

776-8495

One Hamilton County Square

Noblesville, Indiana 46060-2233 August 21, 1995

To: Hamilton County Drainage Board

RE: Hunter's Creek South Sec 1

Attached are as-builts, certificates of completion & compliance, and other information for Hunter's Creek South Sec 1. An inspection of the drainage facilities for this section has been made and the facilities were found to be complete and acceptable.

During construction, changes were made to the drain which will alter the plans submitted with my report for this drain dated May 5, 1984. The changes are as follows: The 27" RCP from structure 109 to structure 108 was shortened from 130' feet to 120' feet. The SSD used was changed from 8" to 6" in diameter. 124'

The length of the drain due to the changes described above is now 5106 feet. 5110'

The bond or letter of credit from Fidelity and Deposit Co. of Maryland, number 98-77-666, dated August 5, 1985, in the amount of \$82,500, has been recommended for release in a letter to the Commissioners dated October 31, 1989.

I recommend the Board approve the drains construction as complete and acceptable.

Sincerely,

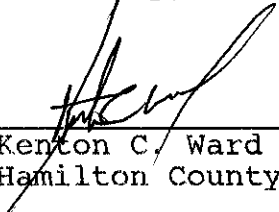
  
Kenton C. Ward  
Hamilton County Surveyor

KCW/nw



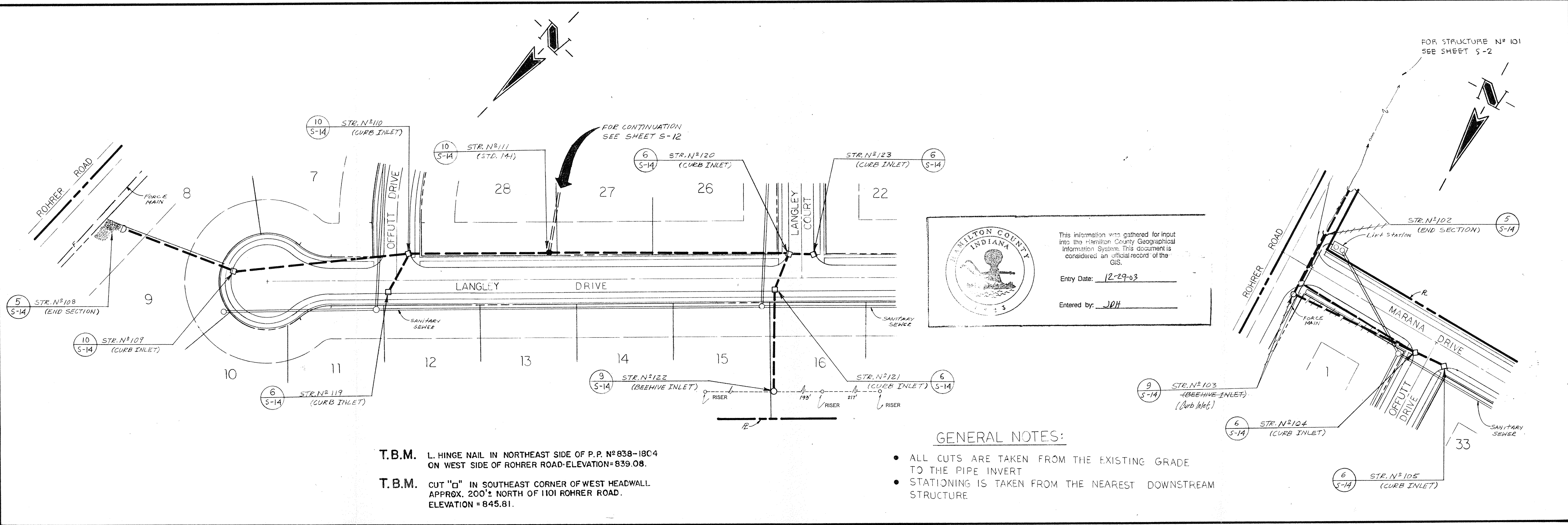

HAMILTON COUNTY INDIANA

This information was gathered for input into the Hamilton County Geographical Information System. This document is considered an official record of the GIS.

Entry Date: 12-29-03

Entered by: JDH

T.B.M. L. HINGE NAIL IN NORTHEAST SIDE OF P.P. N° 838-18C4 ON WEST SIDE OF ROHRER ROAD-ELEVATION=839.08.

T.B.M. CUT "D" IN SOUTHEAST CORNER OF WEST HEADWALL APPROX. 200'± NORTH OF 1101 ROHRER ROAD. ELEVATION = 845.81.

- GENERAL NOTES:
- ALL CUTS ARE TAKEN FROM THE EXISTING GRADE TO THE PIPE INVERT
  - STATIONING IS TAKEN FROM THE NEAREST DOWNSTREAM STRUCTURE

PLAN OF STORM SEWER

SCALE: 1"=50'

RECORD DRAWING 11/27/89  
STORM SEWER

CERTIFICATION FOR "RECORD DRAWING"

CERTIFIED BY: [Signature] (ENGINEER)

JOHN V. SCHNEIDER  
REGISTERED  
NO 14653  
STATE OF INDIANA  
PROFESSIONAL ENGINEER  
12/6/89

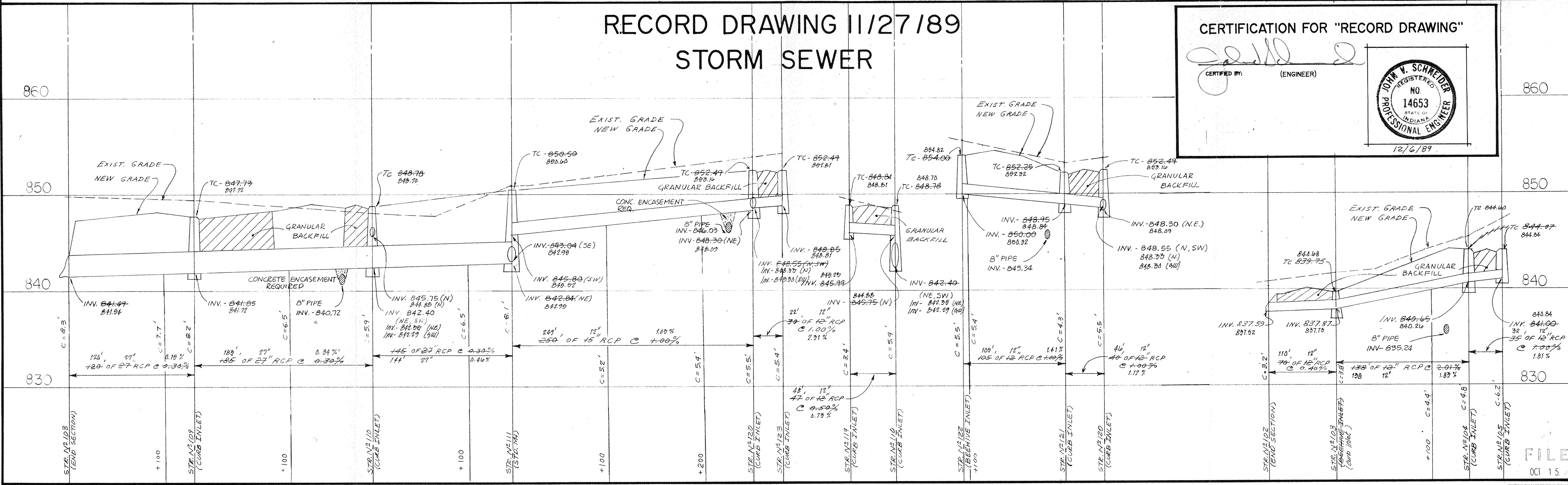

PROFILE OF STORM SEWER

SCALE: VERT. 1"=5'  
HORIZ. 1"=50'

REVISIONS	DATE	CHECK	BY
1	11/27/89	RD	JDH
2	12/29/03	ENR	JDH

DRAWN	DATE	CHECK	NO.	BY
JDH	11/27/89	RD	1	JDH
	12/29/03	ENR	2	JDH

PROJECT	HUNTER'S CREEK SOUTH-SECT 1	277.01
PREPARED FOR	SCHUTZ & THOMPSON INC.	
TITLE	RECORD DRAWING STORM SEWER PLAN	AS NOTED
SCALE	1"=50'	
DATE	OCT 15	
SHEET	S-11	
OF	15	





